



# Electrical and Lighting Solutions

Complete suspension solutions for  
Lighting & Electrical containment



- Aesthetically pleasing
- Easy and efficient installation
- Complete off-site solutions

# Electrical



J-Hook  
*Page 26*



Conduit  
Clamp  
*Page 26*



Fast Trak  
*Page 16*



UniGrip  
*Page 6*

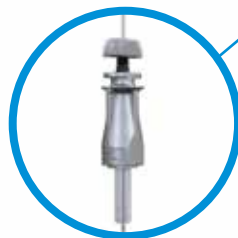

Grippler suspension kits provide complete solutions for electrical installations

Products shown are for internal use only. Images shown for illustrative purposes only.  
Please refer to product installation instructions for full information.



Fast Trak  
Side Loading

Page 18

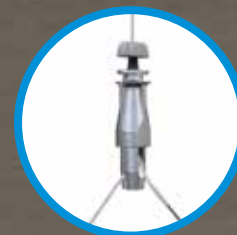

UniGrip  
Y-Fit

Page 7



QT Clamp

Page 26

**The Gripple®** range of supports and hangers for electrical applications has been developed to provide a fast and versatile solution for suspending all types of electrical containment.

**Gripple products** are designed to save time & labour and reduce costs by making the installation quicker and easier. Supplied in ready-to-use kits, the products in this range are lightweight, require no on-site cutting, and reduce the time spent working at heights, offering enormous health and safety benefits for your project.

# Lighting



Express  
Page 8

Express  
Page 8

**The Gripple®** range of suspension solutions for lighting have been designed to save you time, money, and labour by improving the efficiency of the installation process. Unlike traditional suspension methods, Gripple kits eliminate on-site cutting or filing, resulting in much better health and safety benefits for your team.

**Our products** offer a sleek, professional and discreet finish, without compromising on strength, and are supplied in ready-to-use kits with your choice of end fixing and cable length.

# Catenary Kit

Page 14



# C-Clip

Page 14

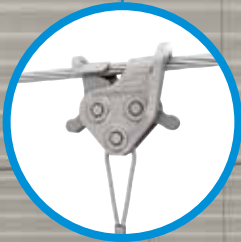

# Angel

Page 10

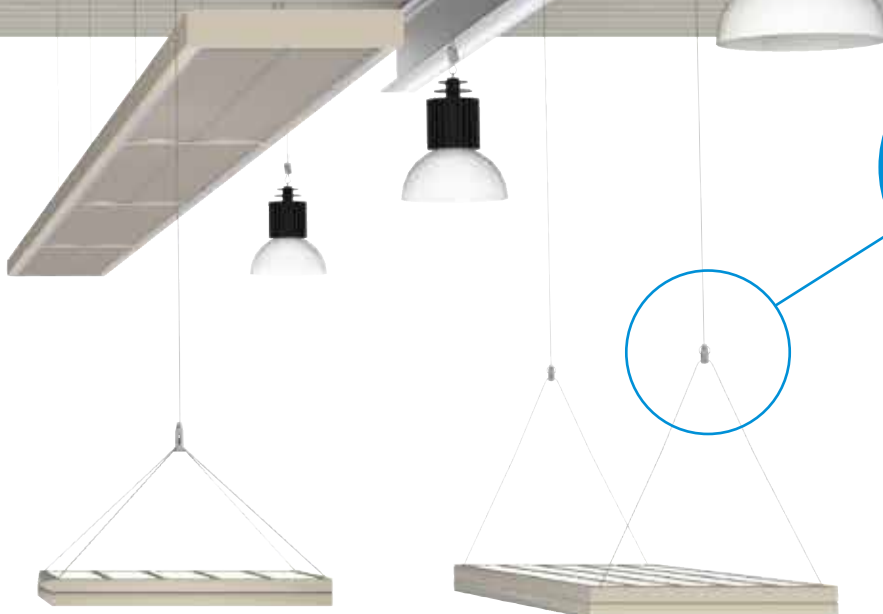
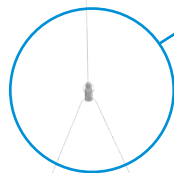

Angel has a wide range of feet options available to suit your lighting application. See page 10 for details

Products shown only for internal use. Images shown for illustrative purposes only. Please refer to product installation instructions for full information.

# UniGrip

Designed for fast suspension of electrical conduits, basket trays, ladder trays and lighting.

**Quick** – up to 6 times faster than traditional suspension systems

**Safe** – can be pre-installed to channel using pre-fitted washer/nut or using retention clip reducing time working at height

**Easy** – integral ergonomically designed release button allows for simple adjustment

**Secure** – button acts as a locking screw and indicator clearly highlights the wire is locked in position for ultimate security

**Versatile** – variety of foot attachments available to suit applications

**Strong** – highest load rating capability to date, up to 550 lb / 250 kg SWL with a 5:1 safety factor

**Approvals** – UL Listed & CSA Approved



(Available with a range of feet options)



## Available Sizes and Load Ratings



**No. 2**  
120 lb / 55 kg  
SWL (5:1)



**No. 3**  
240 lb / 110 kg  
SWL (5:1)



**No. 4**  
550 lb / 250 kg  
SWL (5:1)

All hangers are supplied as ready-to-use kits with a length of cable and end fixing of your choice.

## Installation Steps

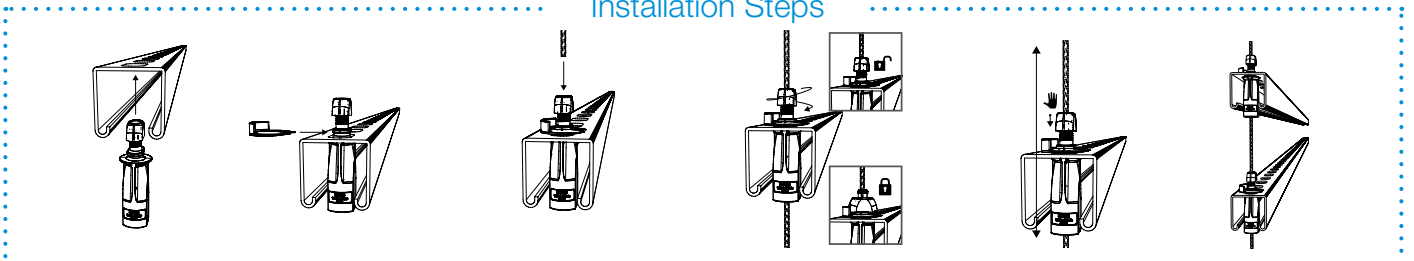

Do not adjust under load. Contact Gripple for full product information, submittal data and technical support.

# UniGrip Feet Options

The range of UniGrip 'feet' ensures the product suits all electrical applications.

## CENTRAL EXIT

with square washer & channel nut / hex nut

- **Ideal for:** conduit racks, cable tray racks, ladder tray racks, busduct. Can be used in multi-tier applications.



## QT

- **Ideal for:** conduit racks, cable tray racks, ladder tray racks, busduct. Can be used in multi-tier applications.



## SIDE EXIT

- **Ideal for:** conduit racks, cable tray racks, ladder tray racks, busduct & lighting.



## HOOK

- **Ideal for:** basket tray. Can be used in multi-tier applications.



## CABLE BASKET ADAPTER

- **Ideal for:** basket tray. Can be used in multi-tier applications.



## Y-FIT

- **Ideal for:** single point suspension of basket tray.



	Standard	Central Exit	Side Exit	Cable Basket Adapter	Y-Fit	QT	Hook
UniGrip No. 2	Available	Available	Available	Available	Available	Available	Available
UniGrip No. 3	Available	Available	Available	Available	Available	Available	Available
UniGrip No. 4	Available	Available	Available	Available	Available	Available	Available

Available
  Unavailable

Supplied as ready-to-use kits with a length of cable, UniGrip Hanger, and end fixing of your choice.

# Express

For the fast suspension of a variety of services, designed with an easy push-button release mechanism.

**Versatile** – Express No. 1 is ideal for signage, shop fitting, lighting and other lightweight fixtures. Express No. 2 is ideal for mechanical and electrical applications

**Quick** – ergonomic buttons allow for rapid adjustment, no Setting Key required

**Safe** – no tools or 'hot works' permit required for installation, improving health and safety on-site

**Aesthetic** – the design complements enclosed and open soffit spaces

**Lightweight** – easy to move and handle on-site, whilst reducing the load on the building structure

**Strong** – industry approved, UL Listed & CSA Approved



BLACK LINE



Available in sizes No.1 - No.2



## Available Sizes and Load Ratings



### No. 1

33 lb / 15 kg  
SWL (5:1)



### No. 2

100 lb / 45 kg  
SWL (5:1)

All hangers are supplied as ready-to-use kits with a length of cable and end fixing of your choice.

## Installation Steps

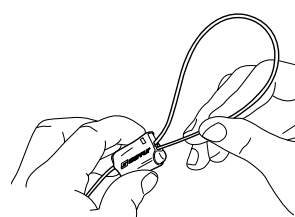
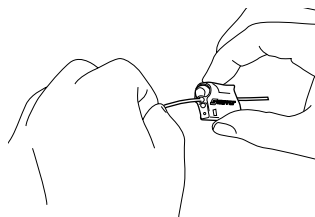
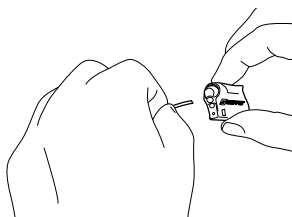

Do not adjust under load. Contact Gripple for full product information, submittal data and technical support.



# Standard Hanger

Cable hanger kit containing the original Gripple fastener, for suspending a variety of electrical services.

**Quick** – fewer components compared to traditional methods, up to six times faster to install than traditional suspension systems

**Safe** – no tools or 'hot works' permit required for installation, improving health and safety on-site

**Strong** – industry approved, UL Listed & CSA Approved

**Lightweight** – easy to move and handle on-site, whilst reducing the load on the building structure

**Aesthetic** – the design complements enclosed and open soffit spaces



BLACK LINE



Available in sizes No.3 - No.5



## Available Sizes and Load Ratings

	<p><b>No. 3</b></p> <p>200 lb / 90 kg SWL (5:1)</p>		<p><b>No. 4</b></p> <p>495 lb / 225 kg SWL (5:1)</p>		<p><b>No. 5</b></p> <p>715 lb / 325 kg SWL (5:1)</p>
---	---	---	--	---	--

All hangers are supplied as ready-to-use kits with a length of cable and end fixing of your choice.

## Installation Steps

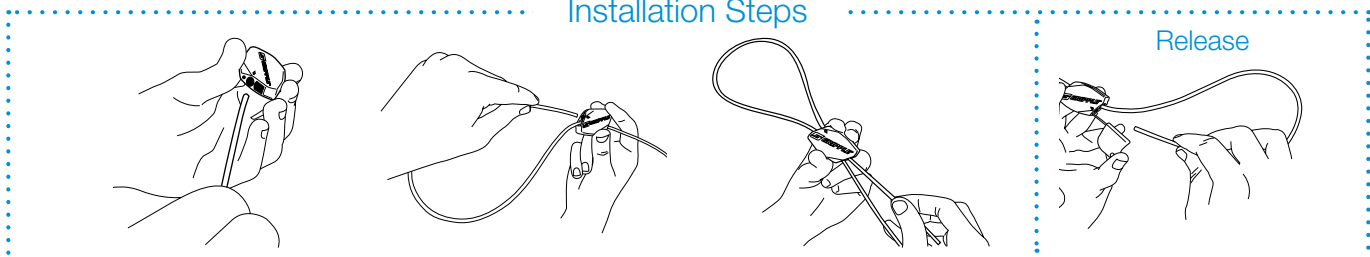

Do not adjust under load. Contact Gripple for full product information, submittal data and technical support.

# Angel

Designed for architectural lighting suspensions, signage, acoustic baffles, and installations where aesthetics are important.

- Aesthetic** – the design complements modern building design
- Discrete** – supplied with 1/16" / 1.5 mm wire for a unobtrusive suspension
- Quick** – ergonomic button allows for easy, rapid adjustment
- Strong** – 33 lb / 15 kg SWL to accommodate a wide range of fittings
- Versatile** – variety of different foot and end fixings for attachment to a wide range of products and substrates
- Safe** – no tools or 'hot works' permit required for installation, improving health and safety on-site
- Approvals** – UL Listed & CSA Approved



Available with a range of feet options



## Available Sizes and Load Ratings



**No. 1**  
33 lb / 15 kg  
SWL (5:1)

All hangers are supplied as ready-to-use kits with a length of cable and end fixing of your choice.

## Installation Steps



Do not adjust under load. Contact Gripper for full product information, submittal data and technical support.

# Angel Feet Options

The Angel fastener is extremely versatile, with a range of feet options available to suit every application.

## Y-FIT

- Dual fixing points for balance
- Ideal for suspending light fixtures
- 6" / 150 mm, 12" / 300 mm and 18" / 460 mm leg lengths as standard
- Various end fixing options for leg attachment to service



## SIGNAGE

- Ideal for signage up to 3/16" / 5 mm in thickness
- Grub screw for direct attachment
- Side cable exit



## HOOK

- Ideal for light fittings, signage, or for use with eyebolts, spring, and wire anchors
- Integrated hook with 3/16" / 4.5 mm clearance
- Safety clasp for security
- Side cable exit



## SIDE EXIT FEMALE

- Female threaded foot, ideal for direct attachment to light fittings, frames and acoustic panels
- Available in M4, M6 and 1/4" thread
- Maximum insertion depth 1/4" / 6 mm
- Side cable exit



## SWIVEL

- Swivel feature for suspension at angles up to 90°
- Available in M4, M6, M8 and 1/4" thread
- Female: maximum insertion depth 1/4" / 6 mm
- Male: 9/16" / 15 mm exposed thread length as standard
- Side cable exit



## KNOCKOUT

- Ideal for strip lighting with standard 7/8" / 22 mm knockout holes
- Slots into knockout centers and twists to lock into place
- No tools needed, or the need to remove the back of the fixture



## SIDE EXIT MALE

- Threaded male foot, ideal for direct attachment to light fittings, frames and acoustic panels
- Available in 1/4" thread as standard.
- 9/16" / 15 mm exposed thread length as standard, custom lengths on request
- Side cable exit (Central Exit also available)



## 4 POINT

- Ideal for light panels with multi fixing points
- Perfect for even balance of square modules
- Side wire exit
- Four Point disc diameter 5/8" / 16 mm



Supplied as ready-to-use kits with a length of cable, Angel Hanger, and end fixing of your choice.

# Y-Fit & Y-Fit Accessory

Ideal for balanced containment and lighting.

**Simple** – Single point suspension with double hanging points to enable one leg to be detached to allow access to cables, etc.

**Versatile** – variety of different end fixings including Snap Hook or Toggle for attachment to a wide range of services and lighting

**Quick & easy installation** – Accessory version is ideal for longer drops to easily reach to services for adjustment

**Safe** – no tools or 'hot works' permit required for installation, improving health and safety on-site



**Strong** – industry approved, UL Listed and CSA Approved

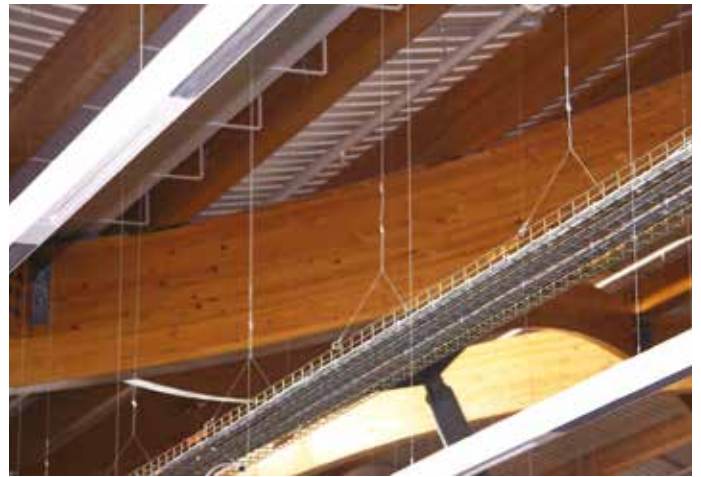

Accessory version available



## Available Sizes and Load Ratings

	<p><b>No. 1</b> 33 lb / 15 kg SWL (5:1)</p>		<p><b>No. 2</b> 100 lb / 45 kg SWL (5:1)</p>		<p><b>No. 3</b> 200 lb / 90 kg SWL (5:1)</p>
---	---	---	--	---	--

All hangers are supplied as ready-to-use kits with a length of wire rope and end fixing of your choice.

## Installation Steps



Do not adjust under load. Contact Gripple for full product information, submittal data and technical support.



# Catenary Kit & C-Clip

Create secure, overhead spans by running high strength cable between two fixed points. Ideal for applications where no direct vertical anchor point is available.

**Versatile** – can easily be used for a variety of applications including lighting and electrical containment

**Quick** – fewer components compared to traditional methods, up to six times faster to install than traditional suspension systems

**Aesthetic** – the design complements enclosed and open soffit spaces providing a discrete finish

**Safe** – no 'hot works' permit required for installation, improving health and safety on-site

**Secure** – locking mechanism in the Lockable Plus prevents dynamic movements

**Approvals** – UL Listed & CSA Approved



Available in 1/8" (3 mm) and 1/4" (6 mm) systems



## Available Sizes and Load Ratings

	<p><b>D3</b> 70 lb / 30 kg SWL (free span) (5:1)</p>		<p><b>D6</b> 220 lb / 100 kg SWL (free span) (5:1)</p>
---	--	--	--

All hangers are supplied as ready-to-use kits with a length of cable and end fixing of your choice.

## Installation Steps

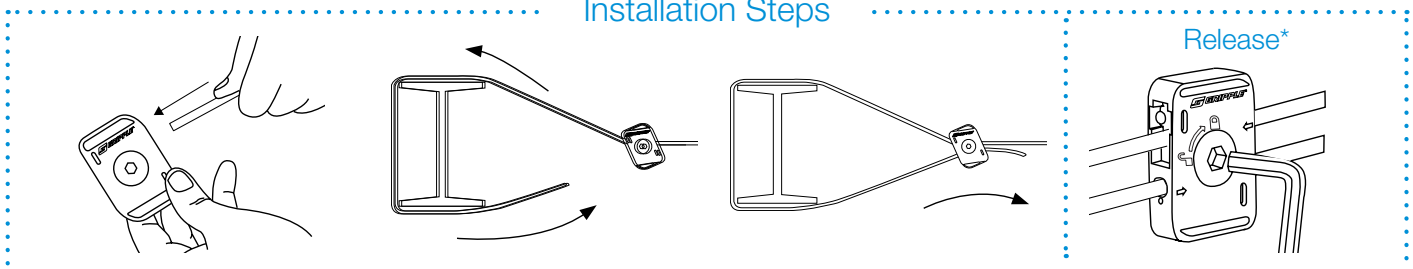

Do not adjust under load. Contact Gripper for full product information, submittal data and technical support.

# Catenary Kit Codes

How to work out your unique product code

1

CHOOSE YOUR PRODUCT



1/8" / 3 mm Catenary Kit  
CTI-1/8



1/4" / 6 mm Catenary Kit  
CTI-1/4

2

CHOOSE YOUR CABLE LENGTH

10FT

15FT

20FT

25FT

50FT

75FT

100FT

Enter your unique product code (e.g. CTI-1/8-75FT):

<input type="text"/>	<input type="text"/>	<input type="text"/>	<input type="text"/>	<input type="text"/>	<input type="text"/>	<input type="text"/>	-	<input type="text"/>	<input type="text"/>	<input type="text"/>	<input type="text"/>	<input type="text"/>
----------------------	----------------------	----------------------	----------------------	----------------------	----------------------	----------------------	---	----------------------	----------------------	----------------------	----------------------	----------------------

PRODUCT

CABLE LENGTH

C-Clip End Fixing can be ordered to suspend any Gripple hanger from the Catenary Kit. (see product code pages)

Catenary Kit Wall Brackets are available as a wall attachment point for the Catenary Kit using the code below.



BLACK LINE

**C-Clip 1/8" / 3 mm**  
End Fixing Code  
CC-1/8

**C-Clip 1/4" / 6 mm**  
End Fixing Code  
CC-1/4



**CAT-BRACKET-4IN**

For further product information please call +1 905 458 8700 or visit our website [www.griipple.com](http://www.griipple.com).

# Fast Trak™



Ideal for Data  
Communication

Pre-fabricated rigid support solution offering speed, flexibility, and efficient use of space, for the installation electrical conduits, basket trays, ladder trays and busduct.

**Quick** – up to six times faster to install than traditional suspension systems

**Safe** – pre-fabricated system which removes the need to cut threaded rod or channel on-site

**Tool free** – bracket can be moved up and down the tracks to accommodate changes in position during installation

**Secure** – safety locks ensure security once brackets and tracks are in place

**Zero waste** – tracks bend neatly under bracket

**Aesthetic** – tracks can be concealed using Fast Trak Bracket Cover for a discrete finish

**Space saver** – can be multi-tiered to accommodate additional services

**Easy measurement** – indicators at each end of the bracket can be used as a measurement guide when marking fixing points in the soffit

**Approvals** – UL Listed & CSA Approved

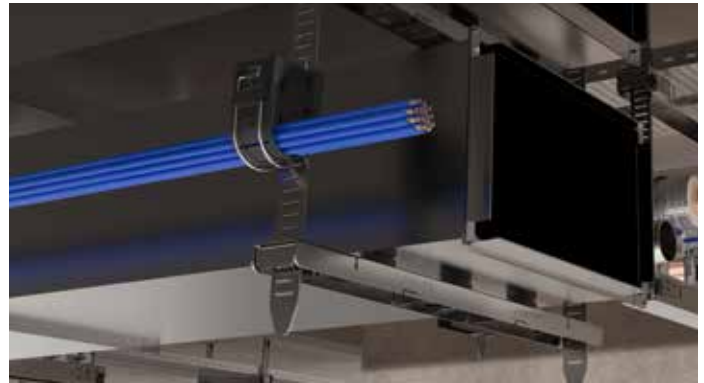

## ..... Available Bracket Sizes .....



<b>FTB-250</b> – 400 lb / 180 kg SWL (3:1)	<b>FTB-600</b> – 400 lb / 180 kg SWL (3:1)	<b>FTB-1050</b> – 200 lb / 90 kg SWL (3:1)
<b>FTB-350</b> – 400 lb / 180 kg SWL (3:1)	<b>FTB-750</b> – 400 lb / 180 kg SWL (3:1)	<b>FTB-1200</b> – 200 lb / 90 kg SWL (3:1)
<b>FTB-450</b> – 400 lb / 180 kg SWL (3:1)	<b>FTB-900</b> – 400 lb / 180 kg SWL (3:1)	<b>FTB-1500</b> – 200 lb / 90 kg SWL (3:1)

## ..... Available Track Sizes .....

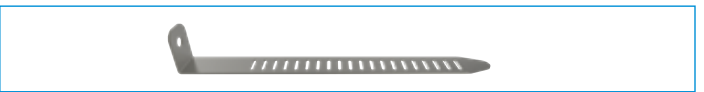

<b>FTT-135</b> – 200 lb / 90 kg SWL (5:1)	<b>FTT-785</b> – 200 lb / 90 kg SWL (5:1)
<b>FTT-285</b> – 200 lb / 90 kg SWL (5:1)	<b>FTT-1035</b> – 200 lb / 90 kg SWL (5:1)
<b>FTT-535</b> – 200 lb / 90 kg SWL(5:1)	

## Installation Steps

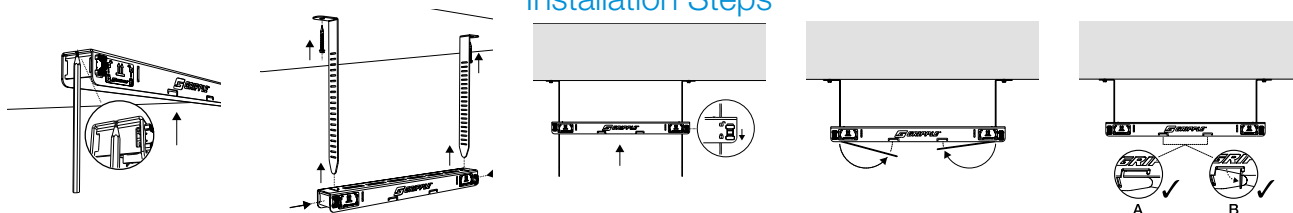

Do not adjust under load. Contact Gripple for full product information, submittal data and technical support.



# Fast Trak™ - Low Profile

A low profile alternative to the standard Fast Trak solution offering greater space efficiency. Ideal for use with electrical conduits, basket trays, ladder trays and busduct.

**Space saver** – 13/16" / 21 mm bracket depth

**Quick** – up to six times faster to install than traditional suspension systems

**Safe** – pre-fabricated system which removes the need to cut threaded rod or channel on site

**Tool free** – brackets can be moved up and down the tracks to accommodate changes in position during installation

**Easy measurement** – indicators at each end of the bracket can be used as a measurement guide when marking fix points in the ceiling

**Aesthetic** – tracks bend neatly under bracket or can be concealed using Fast Trak Bracket Cover



## ..... Available Bracket Sizes .....



<b>FTBL-250</b> – 400 lb / 90 kg SWL (3:1)	<b>FTBL-600</b> – 180 lb / 50 kg SWL (3:1)	<b>FTBL-1050</b> – 70 lb / 20 kg SWL (3:1)
<b>FTBL-350</b> – 400 lb / 90 kg SWL (3:1)	<b>FTBL-750</b> – 140 lb / 40 kg SWL (3:1)	<b>FTBL-1200</b> – 50 lb / 15 kg SWL (3:1)
<b>FTBL-450</b> – 400 lb / 90 kg SWL (3:1)	<b>FTBL-900</b> – 105 lb / 30 kg SWL (3:1)	

## ..... Available Track Sizes .....



<b>FTT-135</b> – 200 lb / 90 kg SWL (5:1)	<b>FTT-785</b> – 200 lb / 90 kg SWL (5:1)
<b>FTT-285</b> – 200 lb / 90 kg SWL (5:1)	<b>FTT-1035</b> – 200 lb / 90 kg SWL (5:1)
<b>FTT-535</b> – 200 lb / 90 kg SWL (5:1)	

## Installation Steps

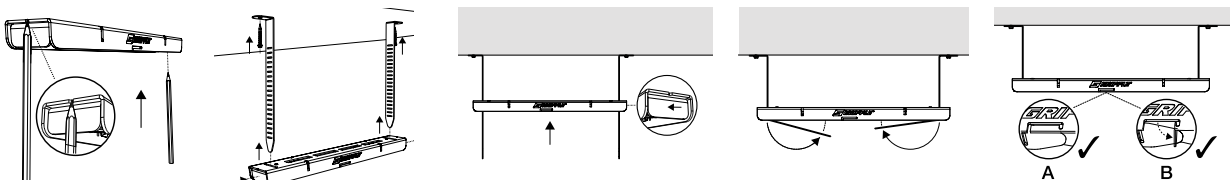

Do not adjust under load. Contact Gripple for full product information, submittal data and technical support.

# Fast Trak™ - Side Loading

Pre-fabricated side loading bracket solution offering speed and flexibility for the installation of lightweight electrical conduits, basket trays, ladder trays and busduct.

- Quick** – up to four times faster to install than traditional suspension systems
- Safe** – pre-fabricated system which removes the need to cut threaded rod or channel on-site
- Tool free** – bracket can be moved up and down the tracks to accommodate changes in position during installation
- Secure** – safety locks ensure security once brackets and tracks are in place
- Space saver** – can be multi-tiered to accommodate additional services
- Easy installation** – lightweight services can be side loaded onto the bracket
- Neat & tidy** – system can be stacked on-site to reduce storage.



## Available Bracket Sizes

	
<p>Single Load</p> <p><b>FTBS-180</b> – 33 lb / 15 kg SWL (3:1)</p>	<p>Twin Load</p> <p><b>FTBT-200</b> – 66 lb / 30 kg SWL (3:1)</p> <p><b>FTBT-300</b> – 66 lb / 30 kg SWL (3:1)</p> <p><b>FTBT-400</b> – 66 lb / 30 kg SWL (3:1)</p>

## Available Track Sizes

<p><b>FTT-135</b> – 200 lb / 90 kg SWL (5:1)</p> <p><b>FTT-235</b> – 200 lb SWL / 90 kg (5:1)</p>

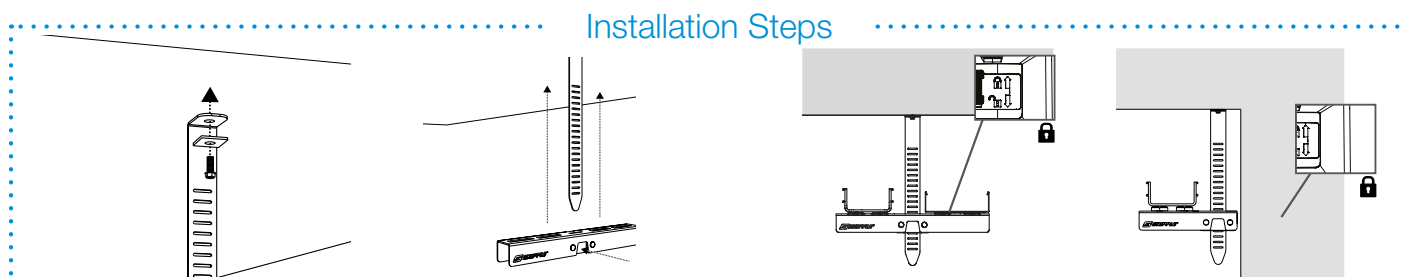

Internal applications only. Do not adjust under load. No dynamic loading.

# Fast Trak™ Kit Codes

How to work out your unique product code:

1

## CHOOSE YOUR BRACKET

### Standard



10" / 250 mm  
FTB-250

14" / 350 mm  
FTB-350

18" / 450 mm  
FTB-450

24" / 600 mm  
FTB-600

30" / 750 mm  
FTB-750

36" / 900 mm  
FTB-900

41" / 1050 mm  
FTB-1050

47" / 1200 mm  
FTB-1200

59" / 1500 mm  
FTB-1500

### Low Profile



10" / 250 mm  
FTBL-250

14" / 350 mm  
FTBL-350

18" / 450 mm  
FTBL-450

24" / 600 mm  
FTBL-600

30" / 750 mm  
FTBL-750

36" / 900 mm  
FTBL-900

41" / 1050 mm  
FTBL-1050

47" / 1200 mm  
FTBL-1200

### Side Loading - Single



7" / 180 mm  
FTBS-180

### Side Loading - Twin



8" / 200 mm  
FTBT-200

12" / 300 mm  
FTBT-300

16" / 400 mm  
FTBT-400

2

## CHOOSE YOUR TRACK LENGTH

### Standard & Low Profile



5 1/4" / 135 mm  
FTT-135

11" / 285 mm  
FTT-285

21" / 535 mm  
FTT-535\*

31" / 785 mm  
FTT-785\*

41" / 1035 mm  
FTT-1035\*

\* Not to be used with Fast Trak - Side Loading brackets.

## OPTIONAL ACCESSORIES



Conduit Clamp  
FTCC-0.75IN  
FTCC-1IN  
FTCC-1.25IN  
FTCC-1.5IN  
FTCC-2IN  
FTCC-2.5IN  
FTCC-3IN  
FTCC-3.5IN



J-Hook  
FTJH-2IN



Trunking  
Clamp  
FTCT-50  
FTCT-75  
FTCT-100  
FTCT-150



CT Clip  
CTC-3MM-BLK-20P  
CTC-3MM-BLK-100P



Vibration  
Dampener  
VDP-100PK



Basket Tray Clip  
CBC-5MM-BLK-20P  
CBC-4MM-GRY-100P  
CBC-4MM-GRY-20P  
CBC-4MM-GRY-100P



Bracket Cover  
FTBC-1110



QT Compact  
Clamp  
GC2-C-24IN



QT Clamp  
GC2-T-24IN

# Low Profile Bracket

Low Profile Brackets can be supplied with quarter-turn accessories for support of electrical services.

**Quick** – pre-cut lengths eliminating the need for cutting channel on-site, allowing more productive use of labour

**Versatile** – can be bolted directly to soffit or wall with less than 5/8" depth and can also be used as a shallow bearer for support of electrical services

**Strong** – up to 330 lb / 150 kg load rating in sizes ranging from 1 ft to 5 ft



## Size Variants



1ft, 2 ft, 3 ft, 4 ft, 5 ft  
305 mm, 610 mm, 914 mm, 1220 mm, 1525 mm  
SWL dependent on load arrangement

## Installation Steps

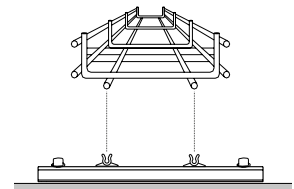
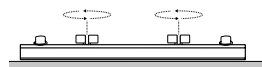
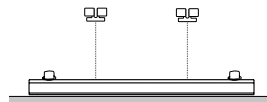

# Universal Bracket

Universal Bracket pre-cut brackets for quick and easy suspension of electrical conduits, basket trays, ladder trays and busducts.



**Versatile** - can be bolted directly to soffit or wall, or suspended using threaded rod or Gripple UniGrip hangers

**Quick** - eliminates the need for cutting channel on site, allowing more productive use of time

**Health and Safety** - no tools required for installation



## Size Variants



1FT, 1.5FT, 2FT, 2.5FT, 3FT, 3.5FT, 4FT and 5FT  
SWL dependent on load arrangement

## Installation Steps

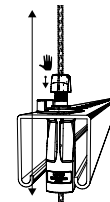
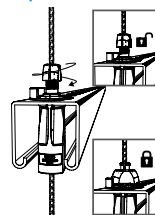
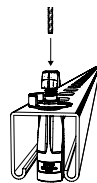
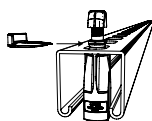
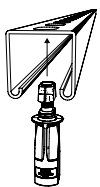

Contact Gripple for full product information, submittal data and technical support.

# Bracket Kit Codes

How to work out your unique product code

## 1 CHOOSE YOUR PIPE BRACKET



Universal Bracket



Low Profile Bracket

1 ft / 305 mm PB1	1.5 ft / 457 mm PB1.5	2 ft / 610 mm PB2	2.5 ft / 762 mm PB2.5	1 ft / 305 mm LPB1	2 ft / 610 mm LPB2	3 ft / 914 mm LPB3	4 ft / 1220 mm LPB4
3 ft / 914 mm PB3	3.5 ft PB3.5	4 ft / 1220 mm PB4	5 ft / 1525 mm PB5	5 ft / 1525 mm LPB5			

## 2 CHOOSE YOUR CLAMP QUANTITY

2	3	4	5	6	7	8
---	---	---	---	---	---	---

## 3 CHOOSE YOUR TYPE OF CLAMP



QT Clamp  
T

QT Compact Clamp  
C

Threaded Clamp  
3/8



To order the GCS Clamp, please use either code GCS-24 or GCS-30

## 4 CHOOSE YOUR PAD OPTION



Standard  
S

Large  
L

Acoustic  
A

Enter your unique product code (e.g. LPB3-3GC2-C-24IN-S):

			-		G	C	2	-				-	2	4	I	N	-	
--	--	--	---	--	---	---	---	---	--	--	--	---	---	---	---	---	---	--

BRACKET

CLAMP QUANTITY

TYPE OF CLAMP

CABLE LENGTH (IN)

PAD OPTION

# Brackets

## Universal Bracket

- Can be bolted directly to soffit or wall, or suspended from the soffit using threaded rod or Grippler UniGrip Hangers
- Eliminates the need for cutting channel on site

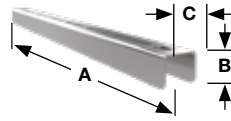

1.6:1 Safety factor

Product code	A	B	C	Max. Single Point Load	Max. Bracket load (above mount)
PB1FT	12" / 304 mm	1 3/8" / 35 mm	1 11/16" / 43 mm	1000 lb / 450 kg	1900 lb / 860 kg
Other increments are available					
PB5FT	60" / 1524 mm	1 3/8" / 35 mm	1 11/16" / 43 mm	250 lb / 110 kg	1200 lb / 540 kg

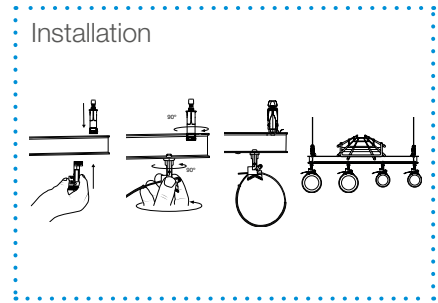

## Low Profile Bracket

- Can be bolted directly to soffit, wall or floor
- Eliminating the need for cutting channel on site, allowing more productive use of labour
- Fix direct or suspend using Grippler UniGrip

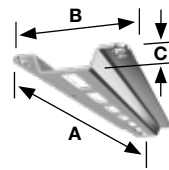

1.6:1 Safety factor

Product code	A	B	C	Max. Single Point Load	Max. Bracket load
LPB1FT	14" / 355 mm	3 5/64" / 78 mm	1/2" / 25 mm	165 lb / 75 kg	330 lb / 150 kg
Other increments are available					
LPB5FT	47" / 1190 mm	3 5/64" / 78 mm	1/2" / 25 mm	165 lb / 75 kg	330 lb / 150 kg

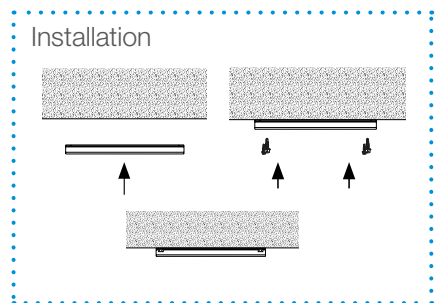

## G-Bracket

- Made for supporting cable tray and basket
- Brackets can be easily joined together either vertically or horizontally with coupling bolts
- Ideal for use with the Y-Fit and Y-Fit Accessory Hangers (page 44)

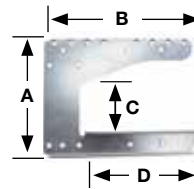

3:1 Safety factor

Product code	A	B	C	D	Max. SWL
G-BRACKET-100	7 3/4" / 200 mm	6 1/2" / 188 mm	3" / 110 mm	4 3/4" / 125 mm	130 lb / 60 kg
G-BRACKET-200	7 7/8" / 200 mm	10 1/4" / 263 mm	3" / 110 mm	7 7/8" / 200 mm	130 lb / 60 kg
G-BRACKET-300	7 7/8" / 202 mm	14 1/2" / 389 mm	3" / 110 mm	12 5/8" / 325 mm	130 lb / 60 kg
G-BRACKET-400	7 7/8" / 202 mm	19 1/4" / 489 mm	3" / 100 mm	16 3/4" / 425 mm	130 lb / 60 kg

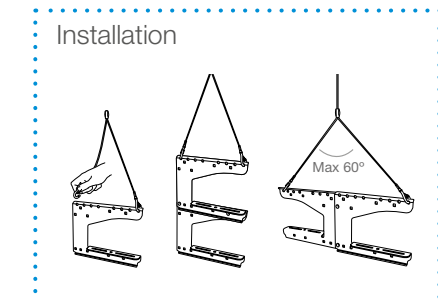

## Catenary Kit Wall Bracket

- 4" x 4" / 100 mm x 100 mm back plate for concrete walls and wooden beams as an attachment point for Catenary Kit
- 4 x 7/16" / 4 x 11 mm diameter mounting holes
- 2 1/2" / 65 mm hole spacing
- 3/8" / 9 mm ring for easy cable attachment
- Zinc plated finish (minimum 5 μ)

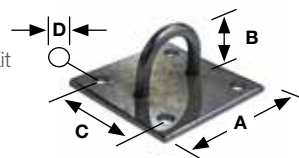

3:1 Safety factor

Product code	A	B	C	D	Max. SWL
CAT-BRACKET-4IN	4" / 100 mm	1 3/4" / 45 mm	2 1/2" / 65 mm	7/16" / 11 mm	750 lb / 340 kg

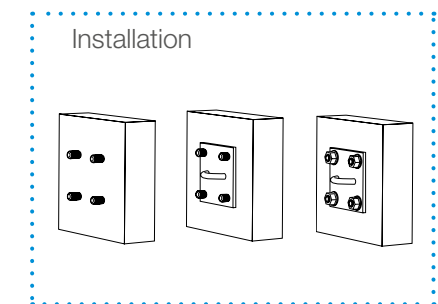

# End Fixings

All Gripple Hanger kits are supplied with a pre-crimped End Fixing and your choice of wire rope length, suitable for installation into any substrate.



## Loop

- Ideal for looping around purlins, beams, roof trusses and other suitable building features
- Available in Gripple sizes No.1 - No.5 with a 5:1 safety factor.
- Available in Stainless Steel



## Stud

- Ideal for anchoring into concrete ceilings and Channel Nuts
- Available in Gripple sizes No.1 - No.4 with a 5:1 safety factor
- Available in Stainless Steel



## Toggle

- Ideal when used as a Y-Fit to suspend lighting
- Available in Gripple sizes No.1 - No.3 with a safety factor of 5:1
- Comes as a complete kit with Gripple wire rope and hanger
- Available in Stainless Steel



## Snap Hook

- Quick and easy attachment to cable basket, purlin clips, light fittings
- Available in Gripple sizes No.1 - No.3 with a 5:1 safety factor



## 90° Eyelet

- Ideal for fixing into concrete, steel or wood using gas or powder activated tools or appropriate screws
- Available in Gripple sizes No.1 - No.3 with a 5:1 safety factor



## Ceiling Anchor

- Ideal for fixing Gripple hangers into concrete
- Knock into a pre-drilled hole, pull with a claw hammer to set
- Available for use with No.1 - No.2 Gripple fasteners. Refer to fastener load ratings; 3:1 safety factor.



## Shot Fire

- Shot fire into concrete, or concrete over metal deck
- Can be installed with gas and powder and battery actuated tools
- Quick and easy fastening solution

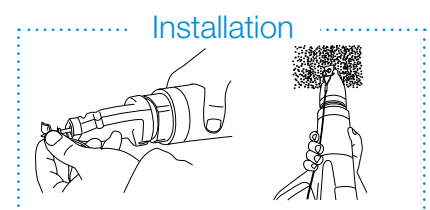
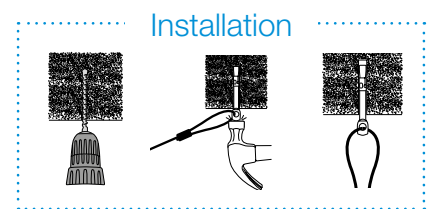
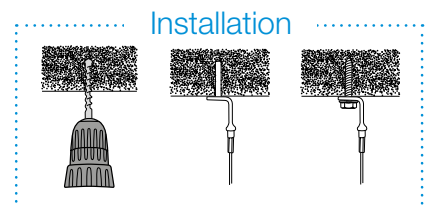
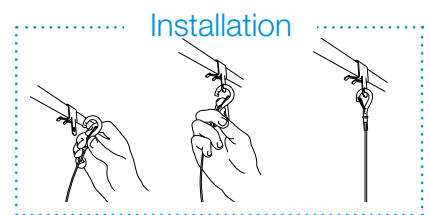
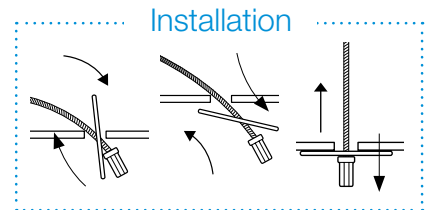
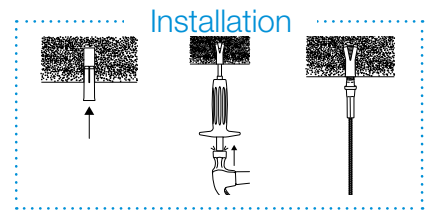
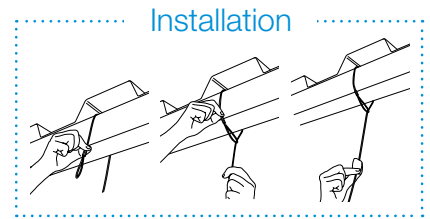

Visit [www.gripple.com](http://www.gripple.com) to view our full range of End Fixings.



# Accessories

A variety of accessories are available increasingly versatility and ease of installation.

## Spring Clip

Used for attaching to top of light fixtures with 1/4" / 6 mm holes.

Product code:  
CLIP-SPG-68



## LSK Clip

General purpose clip to support light fittings Steel with zinc plated finish  
Product code:  
CLIP-LSK



## Tensioning Tool

For use with 1/4" 6 mm Cable Strut kits. Tensions cable easily (up to 220 lbs / 100 kg).

Product code:  
TOOL-5-4BX-INC



## Wire Cutters

Purpose made for up to 1/8" 2.5 mm diameter cable. For use when terminating cable lengths.

Product code:  
CUTTER-GRIPPLE

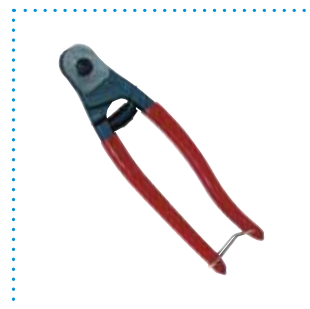

## V-Brackets

Side mount bracket for top of light fixtures (VSM) or front mount bracket (VFM).

Easily fits into mounting holes.

Product codes:  
BRACKET-VSM  
BRACKET-VFM

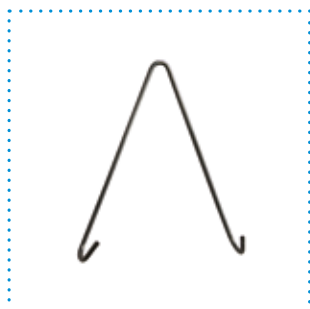

## GF Bracket

Ideal for clamping onto an I-Beam when it is not possible to loop around with cable, or when the height of the beam is too great.

Product codes:  
GF12-EYENUT  
GF20-EYENUT  
GF30-EYENUT



## Beam Clips

Available in a variety of sizes and models for attachment to beams and roof joists. Contact us for sizing and product code options.

Product codes:  
GCB24  
GCB59  
GCB1016  
GCB1720



## T-Bar Twist Clip

Ideal for attaching to suspended ceilings

Integral 1/4" male thread  
Ideal for use with the 1/4" Barrel End Fixing  
Suitable for 1" / 25 mm T-Bar  
Product codes:  
TBAR-CLIP-Q



# Accessories

## Conduit Clamp

Quarter turn attachment to Gripple brackets and Fast Trak for quick installation of conduit.

- No specialist tools required for installation
- Available in sizes from 3/4" to 3 1/2"
- Supports rigid and EMT conduit
- Pre-assembled with nut and bolt



## Trunking Clamp

Quarter turn attachment to Gripple brackets and Fast Trak for quick installation to trunking and busduct.

- No tools or additional fixings required
- Available in 4 sizes: 2x2 inch / 50 x 50 mm, 3x3 inch / 75 x 75 mm, 4x4 inch / 100 x 100 mm, 6x6 inch / 150 x 150 mm
- Integral, hinged latch retains trunking in position
- Suitable for use with PVC and steel trunking

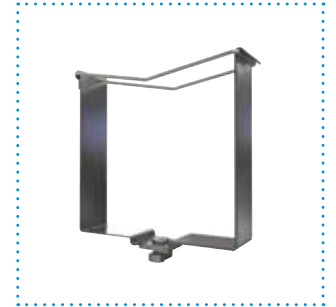

## QT Universal Clamp & QT Compact Clamp

Gripple brackets and Fast Trak for an alternative conduit support system.

- Integral mounting pillar and quarter turn attachment
- No tools required for installation
- Universal, fits all sizes of conduit up to 6"



## J-Hook

Used in conjunction with Fast Trak tracks to support all types of data cables.

- Gate 'lock off' can be re-opened to add additional cables
- High performance, wide base wire form design
- Fast connection onto the Fast Trak track
- 2" / 50 mm diameter; can also be used for VRF/condensate pipes



## Basket Tray Clip

For quick fastening of basket tray to Gripple brackets.

- Prevents uplift and slide of basket
- Two sizes available to fit 5/32" / 4 mm and 3/16" / 5 mm basket wire
- Tool-free, quarter turn installation
- Time saving compared to traditional methods



## Bracket Cover

Neatly hides tracks to further enhance the aesthetics of the Fast Trak system.

- Discreet finish; ideal for open soffit spaces
- Tool free and simple 'snap fit' installation
- Can be cut down to specific lengths
- Covers metal edges that would usually protrude below the bracket



# Case Studies

Molson Coors page 28

Kananaskis Emergency Response Centre page 29



# CASE STUDY

**Molson Coors**  
Montréal, Québec, Canada





TIME SAVINGS  
**300 HOURS**

WORKING WEEKS SAVED\*  
**7.5 WEEKS**

LABOUR SAVINGS  
**\$18,000**

The new multi-purpose Molson Coors 2,000,000 sq.ft building in Molson, will provide a new warehouse and head office. Gripple supplied the [Express](#) hangers and [Low Profile Brackets](#) on this project for the suspension of all lighting.

Project Summary	
<b>Building type</b>	Commercial
<b>Consultant</b>	CIMA +
<b>Main Contractor</b>	Pomerleau
<b>MEP Contractor</b>	Dawco Electrique
<b>Building structure</b>	Metal Deck
<b>Services</b>	Light Fixtures

Featured Products	
<p>Low Profile Bracket</p> 	<p>Express</p> 



“The main benefits for me were the [logistics](#) and [maximizing the space](#) in the lift as the deck is 100 ft high from the ground. We [saved on labour](#) as we were able to start installing straight away. The Gripple system is [easy for us to use](#) and adjust as we anticipate changes on the job.”

- Sylvain Barbe, Superintendent/ Foreman, Dawco Electrique -

## COST SAVING SUMMARY

	Gripple solution	Traditional method
Overview	<b>Express No.2 with QT Barrel and 2FT Low Profile Bracket</b>	Jack Chain, S Hooks, Bracket to attach to the deck
Material cost	<b>\$24,450</b>	\$15,120
Installation time	<b>249 hours</b>	549 hours
Labour rate (per hour)	<b>\$60</b>	\$60
Total labour cost	<b>\$14,940</b>	\$32,940
Total cost	<b>\$39,390</b>	\$48,060

# CASE STUDY

**Kananaskis Emergency Response Center**  
Kananaskis, Alberta, Canada



TIME SAVINGS  
**364 HOURS**

WORKING WEEKS SAVED\*  
**9 WEEKS**

LABOUR SAVED  
**\$17,600**

Kananaskis Emergency Services Centre is part of an \$18.5 million government funded project to provide a replacement facility, which will offer fire and advanced life support ambulance services, as well as a 24 hour dispatch centre. Gripple supplied the [Express](#) hanger kits and [GS 12 Kits](#) for this project.

Project Summary	
<b>Building type</b>	Post-Disaster Emergency Response Center
<b>Main Contractor</b>	CLARK Builders
<b>MEP Contractor</b>	Blazer Mechanical (Plumbing), West-Air (HVAC), Quigley Electrical (Electrical)
<b>Building structure</b>	Concrete and Metal Decking
<b>Services</b>	Lighting, secondary supports, seismic restraint

**Featured Products**

Express



GS Kits





“This was my first time using Gripple and just something as simple as hanging the high bay lights was so much [easier](#). [Adjustability](#) and the idea that I didn’t have to deal with chain was a game changer.”

- Alan, Electrical Foreman, Quigley Electrical -

..... **COST SAVING SUMMARY** .....

	Gripple solution	Traditional method
Overview	<b>GS 12 kits, Express No.1</b>	Rigid bracing, Jack Chain
Material cost	<b>\$24,000</b>	\$8,000
Installation time	<b>20 hours</b>	384 hours
Labour rate (per hour)	<b>Electrical: \$60.00, Mechanical: \$50</b>	Electrical: \$60.00, Mechanical: \$50
Total labour cost	<b>\$2,560</b>	\$20,160
Total cost	<b>\$26,560</b>	\$28,160

\*Figure based on one installer working for eight hours a day

# Notes

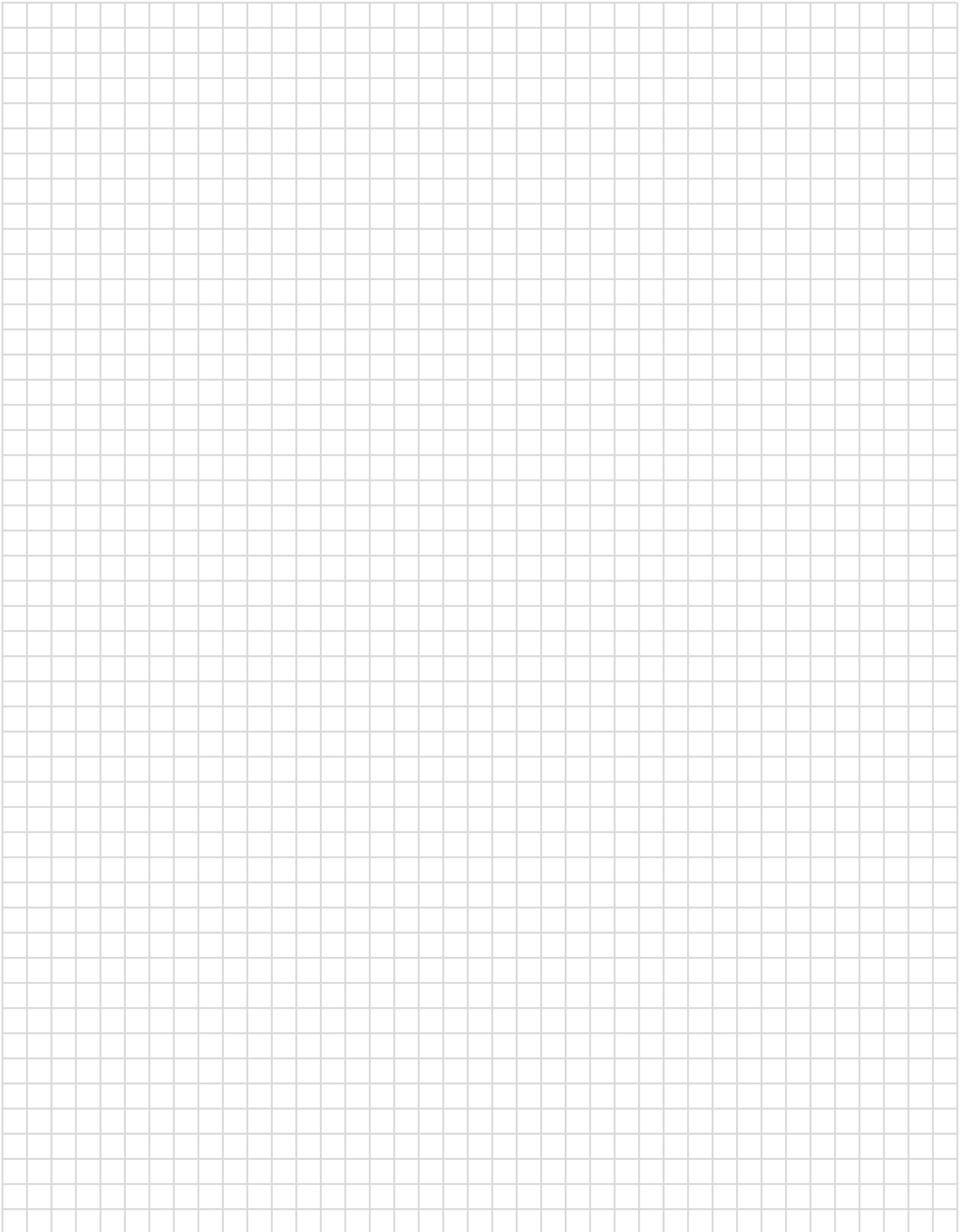

# Usage Recommendations

Failure to comply with these recommendations may result in product malfunction and possible damage to property or person and will invalidate the Gripple guarantee. Gripple products are guaranteed to be free from defects in materials and workmanship in accordance with our terms and conditions. No other warranty, whether express or implied, including any warranty of merchantability or fitness for purpose shall exist in connection with the sale or use of any Gripple product.

Full technical information and installation instructions should be obtained directly from Gripple Limited, Gripple Europe, Gripple Inc., Gripple Japan, Gripple Poland, Gripple India, Gripple Germany, any regional Gripple office, or via the website ([www.gripple.com](http://www.gripple.com)). These Key Recommendations may be amended from time to time; please view the Key Recommendations page on the Gripple website ([www.gripple.com](http://www.gripple.com)) for the most up-to-date information.

Please adhere to the following usage recommendations:



## Loads

Always operate the product within its stated safe working load range.



## Hanging at an angle to vertical

Ensure that the load calculation considers the effect of 'side load'. For example, at an angle of 60° to vertical the SWL is effectively reduced by 50%.



Ducting: When installing included angle teardrop hangers on round/spiral ducting or pipes, the final included angle of the assembly should not exceed 60°.



Y-Fit: Legs on Y-Fit not to be installed greater than 60°.



## Environment

Do not use in chlorinated or chemically corrosive atmospheres. Standard hangers are for use in dry and air conditioned environments only. Stainless steel hangers should be considered for high to saturated humid environments after validation by a competent person.



Not suitable for swimming pools.



## Joining

Never join two ends together in-line.



## Traceability

Always use the Gripple hanger with the specified wire rope supplied by Gripple. Gripple products should only be used with products supplied by Gripple Ltd., and the warranty will not apply if our products are used with any products supplied by third parties.



## Lifting

Do not use for lifting, either by crane or as part of a pulley system. Suspend static loads only.



## Impact

If there is potential for impact on the wire rope suspension or suspended services, seek advice from Gripple Ltd. Technical Services prior to installation.



## Lubrication

Do not apply oil or any other lubricant to the hanger or any other part of the assembly.



## Wire Rope

Trim any damaged filaments with the wire cutter before use.



## Installation

Do not walk or stand on the Gripple product installation. Gripple products must not be used for personal suspension, fall protection or harnessing people.



## Painting

Do not paint the hanger prior to installation. Ensure the hanger is in its final position prior to applying any paint to the wire rope assembly. Do not move the fastener after painting.



## Storing

Do not store the product outdoors, or in damp or abnormal conditions.

## Quality & Approvals

Gripple UK is ISO 9001:2015 and ISO 14001 certified. Gripple products meet the highest standards of quality with lowest environmental impact.



Gripple's policy is one of continuous development and innovation. We therefore reserve the right to alter specifications, etc. without notice.

# www.gripple.com

cainfo@gripple.com



## Gripple Canada Inc

6665 Tomken Road  
Units 9 - 10  
Mississauga, ON L5T 2C4  
Canada

**T** | +1 905 458 8700

**F** | +1 647 660 2096

**E** | cainfo@gripple.com

### Gripple Ltd (Headquarters)

The Old West Gun Works  
Savile Street East  
Sheffield S4 7UQ  
UK

**T** | +44 (0) 800 018 4264

**F** | +44 (0) 114 275 1155

**E** | info@gripple.com

### Gripple Europe SARL

1, rue du Commerce  
BP 37  
67211 Obernai Cedex  
France

**T** | +33 (0)3 88 95 44 95

**F** | +33 (0)3 88 95 08 78

**E** | frinfo@gripple.com

### Gripple Inc

1611 Emily Lane  
Aurora  
IL 60502  
USA

**T** | +1 866 474 7753

**F** | +1 800 654 0689

**E** | grippleinc@gripple.com

### Gripple India

C-115, Industrial Area  
Phase I, Naraina  
New Delhi-110028  
India

**T** | +91-11-45136817

**F** | +91-11-45136817

**E** | ininfo@gripple.com

### Gripple Japan K.K

2-57 Tsukizi-cho  
Hyogo-ku, Kobe-shi  
Hyogo, 652-0845  
Japan

**T** | +81 (0) 78 681 2121

**F** | +81 (0) 78 681 2122

**E** | japan@gripple.com



A GLIDE company



**BUS-BROC-MEP-CAN-ENG-3238**

Published August 2020

Please refer to [www.gripple.com](http://www.gripple.com) for  
the most up to date user advice and  
product information.



© 2020 Gripple.

Gripple is a registered trademark of Gripple Limited.  
Company registered in England No. 1772901, VAT Reg No. GB 600 1951 88